

*Designed by*  
FENDER KATSALIDIS

V

S

O

3

VICTORIA SQUARE  
*by Growland*

## Your West-Side Story.

On the cusp of the CBD, a new chapter begins at Victoria Square. Here at VS.03, impeccably crafted residences from the acclaimed Fender Katsalidis offer spacious and light-filled one, two or three bedroom homes from which to explore the surrounding delights. With architecture inspired by the rich history of the suburb and its significant river, Victoria Square is a new landmark address with a real depth of character.

This is a tale that invites endless discovery, with a lively dining and retail precinct on the ground and a spectacular 2400sqm garden in the sky. An across-the-bridge, riverside address with true class and charm, your VS.03 story starts here.



*“We wanted to celebrate a sense of ownership and belonging to a place. That’s why we’ve woven the spirit of Footscray and the contour of the river through the design. The pattern isn’t just an afterthought, it’s essential to how the building is constructed and experienced.”*

JAMES PEARCE, DIRECTOR  
FENDER KATSALIDIS



## Just across the river.

What Brooklyn is to New York, Footscray is to Melbourne. Nestled between the vibrant neighbourhoods of Kensington and Yarraville, and only 3.9km from the CBD, Footscray is one of the city's new über-cool cultural hubs. A gateway to the west as well as the city centre, the fashionable suburbs of Williamstown, Seddon, and popular beaches are all close by.

- |                                |                               |                                 |
|--------------------------------|-------------------------------|---------------------------------|
| 1 — Melbourne University 4.3km | 4 — Tullamarine Freeway 2.3km | 7 — Docklands 2.5km             |
| 2 — Flemington Racecourse 1km  | 5 — Melbourne CBD 3.9km       | 8 — Albert Park 6.4km           |
| 3 — Maribyrnong River          | 6 — Crown Complex 4.8km       | 9 — Footscray CBD & Market 600m |



## Residences

---

*“We aimed to find a balance for the interiors between the historical story of Footscray—the down to earth, edgy vibe—and the contemporary urban scene that’s lively and bespoke. We want people to feel that they really belong to a place.”*

---

CASSANDRA FAHEY, INTERIOR DESIGNER  
FENDER KATSALIDIS



Living room – Artist's impression

### A tale of class and charm.

From the palette to the architectural form, VS.03. is inspired by its surrounds. A rhythmic pattern runs across the façade, with the use of concrete and shading providing a depth of texture that extends into the interiors. While hues and materials are light and subtle, small details provide a distinct edge, from strong sculptural blocks in kitchens to timber vanity units in bathrooms. But in these elegant homes, the true story is one of light, space, quality and luxury.



Living room – Artist's impression

Kitchen, light scheme — *Artist's impression*Kitchen, dark scheme — *Artist's impression*Bathroom, light scheme — *Artist's impression*Bathroom, dark scheme — *Artist's impression*

## Light Scheme.

Residents at VS.03 can select between two distinct colour schemes for their interiors: light and dark. For the former, a palette of whites and light greys provide a simple elegance, with pale stone benches and bathroom tiling adding to a sense of soft brightness.

## Dark Scheme.

In contrast to the light colour hues, the dark colour scheme for VS.03 provides a bolder, although no less elegant palette. Charcoal tiling in bathrooms and darker grey cupboards and stone benches offer a natural complement to timber flooring and walls.





City views — Artist's impression

### Peaceful and picturesque.

Wake up every morning to a sunrise over Melbourne. Within each VS.03 residence, spacious bedrooms offer impressive views over the river and the CBD or out to the bay.

## Amenities

---

*Whether seeking a quiet area for solitude,  
or a beautifully appointed space to gather with  
family, friends and neighbours, Victoria Square  
has the perfect space.*



Victoria Square's podium — Artist's impression



Victoria Square's laneway — Artist's impression

### A new dining destination.

While Footscray has many eats and treats to savour, you'll rarely want to venture further than Victoria Square for a delicious feast. At the heart of the development is a thriving retail and dining destination inspired by the laneways and arcades quintessential to Melbourne. From cafés and bars to supermarkets and restaurants, this 3000sqm precinct offers everything to satisfy even the most selective of tastes.

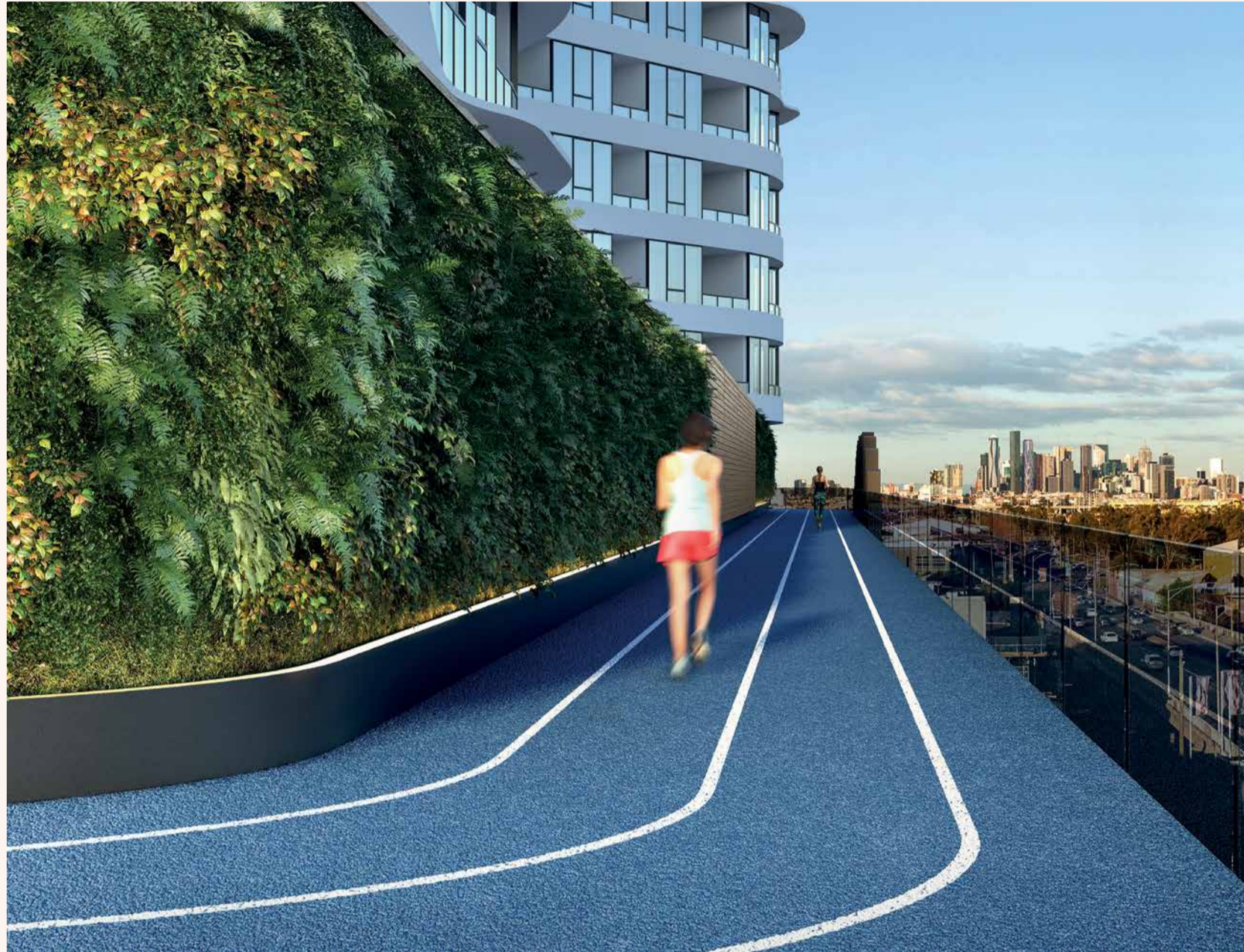

VS.03 Lobby – Artist's impression

400m elevated outdoor track — *Artist's impression*

## A lifestyle to savour.

When it comes to world-class amenity at Victoria Square, there's so much to tell. Here, history is being made with the inclusion of Australia's only Olympic-sized aerial outdoor track. The lush 2400sqm Sky Garden atop of Victoria Square's four level podium offers jaw-dropping panoramas over the city. A heated indoor pool with a backdrop of Melbourne's skyline provides the perfect place to start the day, while a fully equipped gymnasium allows you to work out conveniently and safely without leaving the comfort of home.

For special entertainment, a private dining room with a fully-equipped commercial kitchen and bar offers an ideal space to host get-togethers and dinner parties, all with spectacular tableaux over the city.

Residents' game's room — *Artist's impression*Residents' cinema — *Artist's impression*Residents' gymnasium — *Artist's impression*Residents' swimming pool — *Artist's impression*



Sky Garden — Artist's impression

# Growland × Fender Katsalidis

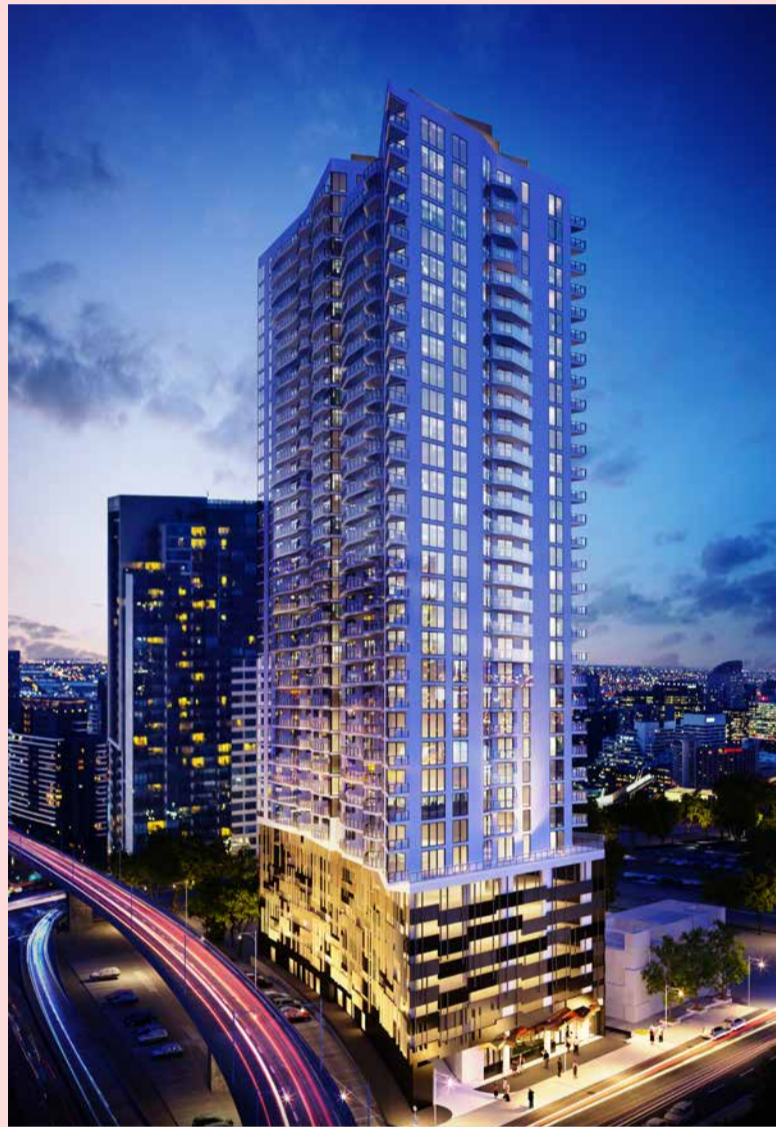

Marco by Growland — Artist's impression



Eureka Tower designed by Fender Katsalidis — Photo by John Gollings

This exciting collaboration between two innovative companies is destined to raise the benchmark of architectural and development practice. Both Fender Katsalidis and Growland are committed to visionary, future-oriented projects, forged through strong collaborations. Fender Katsalidis' multi-award winning international design practice creates a new standard for creativity and sustainability across the world; Growland's strong background in joining with industry experts and delivering world-class developments makes this the perfect partnership.

GROWLAND.COM.AU  
FKAUSTRALIA.COM

Disclaimer statement: Growland Group Pty Ltd (ACN 166 902 629) and its associated entities have endeavoured to ensure the information in this brochure is correct, it is to be used as a general guide only. The representations shown are artistic impressions only. In particular, the plans, images, dimensions, sizes and areas, facilities, amenities, infrastructure, the configuration of these and other information contained in this brochure (Property Information) are indicative only and may change depending on a range of variable factors including, but not limited to, council building approvals and planning consents, market conditions, finance and government and municipal requirements. Furniture and home decorator items are for illustrative purposes only and are not included in the purchase price or in any contract for the sale of property referred to in this brochure. As a result, the Property Information is preliminary only and subject to change without notice. We recommend that you undertake your own enquiries, obtain independent legal advice and confirm the current Property Information at the time you enter into any purchase contract. This brochure has been produced for general information purposes only and does not constitute part of an offer or contract for the sale of any property referred to in this brochure. Growland Group Pty Ltd (ACN 166 902 629) and its associated entities do not make any representations or give any warranties that the information set out in this brochure is or will remain accurate or complete at all times and they disclaim all liability for harm, loss, costs or damage which arises in connection with any use or reliance on the information.



VIC-SQ.COM.AU



GROWLAND