

*FINAL PRODUCT MAY BE SLIGHTLY DIFFERENCE BASE ON THE FLOOR PLAN DESIGN



TURNKEY INCLUSIONS

- › 2590mm Ceiling Height through out
- › Bricks infill to all windows and sliding doors
- › LED downlight throughout
- › 20mm Stone Benchtops to Kitchen, ENS and Laundry vanity
- › 900mm Tisira Cooktop and Rangehood Upgrade
- › Laminate Wall Panels to the back of the Rangehood
- › Designer range Tapware Upgrade
- › Undermount basin to all bathroom, Ensuite and powder room
- › Back-to-wall designer Toilet Upgrade
- › Freestanding bath Upgrade
- › Laminate timber flooring Upgrade
- › Flyscreens to all Openable Windows and Flyscreens doors to all Sliding Doors
- › Holland Blinds to all Windows and Sliding Doors
- › Alarm Security System and Smoke Detectors
- › 5 star Gas ducted heating
- › Evaporative Cooling to house
- › Colour though Paving Driveway
- › Front and Rear Landscaping with letter box
- › Full Shared Fencing with Wing Fence and Side Gate

MAC
Melbourne Architectural Constructions

artTM
RESIDENCE
BY MAC

Lot 2211 Five Farms

Titled Land

Land Size 469m²

Land Price \$493,000

Turnkey Price \$374,950

Package Total \$867,950

› FIXED SITE COST

› 3 MONTH MAINTENANCE

› 10 YEAR STRUCTURAL GUARANTEE

BARNETT 22



House Area

200.91m²
21.62sq

House Size

(Width X Depth)
11.26m x 20.62m

Min. Lot Size

Width 12.5m +
Depth 28.0m +
(Including 2m Easement)



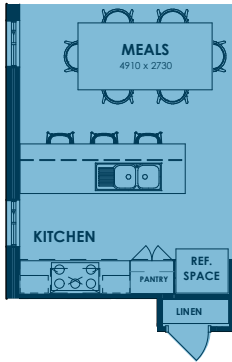

Option 1
Alternative Kitchen
Layout
instead of standard

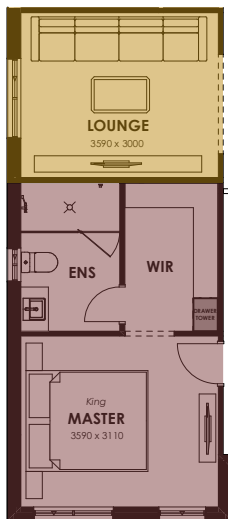
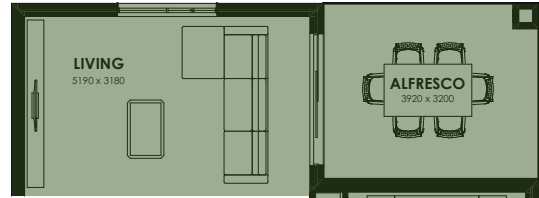

Option 2
Master & Lounge reversed
to have Master at the front
instead of the Lounge



Option 4
Alfresco instead
of Bed 4



Option 3
Bed 5 with built
in robe instead
of Lounge in
option 2